

Detectors, Control & Distribution

HD1

Heat Detector – Explosionproof & Intrinsically Safe

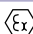

| | |
|---|---|
| Certification |  ATEX, GOST 'R' & 'K', Chinese Flameproof Increased Safety Intrinsically Safe |
| Certified Ambient Temperature | -20°C to +125°C EExd (T3) ATEX/GOST 'R' -20°C to +55°C EExd (T6)/EEExm -55°C to +55°C EExia |
| Ingress Protection | IP66 & 67 |
| Material | Marine Grade Alloy (EExd) Corrosion-free GRP (EExia/EEExm) |
| Temperature Settings | 140°F to 725°F (60°C to 385°C) |
| Entries | 2 x 20mm |
| Weight | 1.1-2.0kg (model dependent) |
| Options: Enclosures, colour, tag and duty labels, temperature setting | |

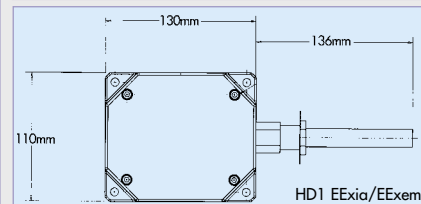
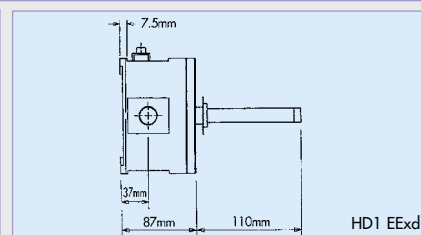

82E, 8DTWP, SM87JB

Cast Iron Junction Boxes Explosionproof

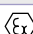

| | |
|--|--|
| Certification |  ATEX Flameproof Increased Safety |
| Certified Ambient Temperature | -20°C to +50°C |
| Ingress Protection | IP66 & 67 |
| Material | Stainless Steel, Alloy or Cast Iron |
| Entries | Up to 4 x 20mm or 25mm |
| Weight | 1.3-3.5kg (model dependent) |
| Options: Body colour, tag label, terminals | |

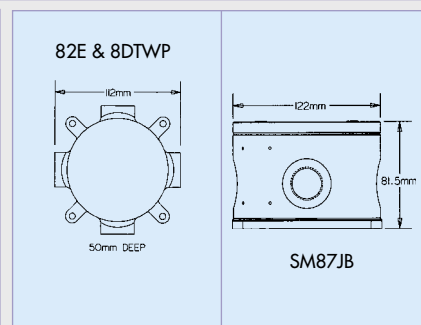



Standard models. Available ex-stock.

| Certification | Ordering Code | Model | Standard Product Configuration |
|---------------|---------------|--------|--|
| ATEX Ex II 2G | 820005 | 82E | Standard models have BK6 terminals, 4 x 20mm entries, 1 per face, cast iron painted grey. |
| ATEX Ex II 2G | 820010 | SM87JB | |

JB10 & JB11

GRP Junction Boxes – Explosionproof

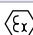

| | |
|--|---|
| Certification |  ATEX  US Increased Safety |
| Certified Ambient Temperature | -55°C to +55°C (model dependent) |
| Ingress Protection | IP66 & 67 |
| Material | Corrosion-free GRP |
| Entries | Up to 8 side/4 base entries |
| Weight | 1.1kg-1.8kg approx |
| Options: Body colour, tag label, terminals, external earth, gland continuity, LED, stainless steel fittings, side cable entries, high temp. version (up to +125°C) | |

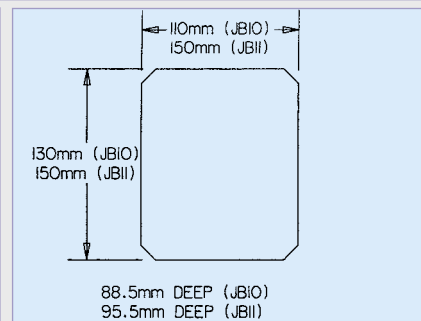

Standard models. Available ex-stock.

| Certification | Terminals | Ordering Code | Model | Standard Product Configuration |
|---------------|-------------|---------------|-------|--|
| ATEX Ex II 2G | 6 x SAK 2.5 | 810001 | JB10 | Standard models have earth terminal, gland continuity, 4 x M20 entries, 1 on each face, natural black finish. |

Download data sheets from www.medc.com