

Cable tray accessories 35, 60, 85, 110

Joint plate

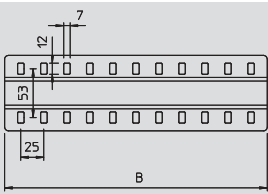

Type	Width mm	Pack. pcs	Weight kg/% pc	Item No. ST / FS	Price €/pc
SSLB 100	85	20	7.700	7070 20 5	
SSLB 150	135	20	12.200	7070 20 9	
SSLB 200	185	20	16.700	7070 21 3	
SSLB 300	285	20	25.700	7070 21 7	
SSLB 400	385	20	34.700	7070 22 1	
SSLB 500	485	20	43.700	7070 22 5	
SSLB 550	535	20	48.200	7070 22 9	
SSLB 600	585	20	52.700	7070 23 3	
				ST / DD	
SSLB 100	85	20	7.700	7070 30 6	
SSLB 150	135	20	12.200	7070 31 0	
SSLB 200	185	20	16.700	7070 31 4	
SSLB 300	285	20	25.700	7070 31 8	
SSLB 400	385	20	34.700	7070 32 2	
SSLB 500	485	20	43.700	7070 32 6	
SSLB 550	535	20	48.200	7070 33 0	
SSLB 600	585	20	52.700	7070 33 4	



Wide joint plate for use in all cable trays and wide span cable trays.

Including appropriate fastening material.

Bottom end plate

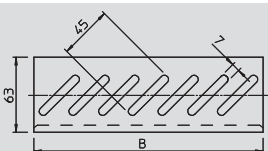

Type	Width mm	Pack. pcs	Weight kg/% pc	Item No. ST / FS	Price €/pc
BEB/050	50	100	2.500	7083 04 1	
BEB/100	100	100	5.400	7083 10 6	
BEB/150	150	100	8.400	7083 15 7	
BEB/200	200	100	11.400	7083 20 3	
BEB/300	300	100	17.200	7083 30 0	
BEB/400	400	100	23.100	7083 40 8	
BEB/500	500	50	29.000	7083 50 5	
BEB/550	550	50	32.000	7083 55 6	
BEB/600	600	50	35.000	7083 60 2	
				ST / DD	
BEB/050	50	100	2.500	7083 61 6	
BEB/100	100	100	5.400	7083 61 8	
BEB/150	150	100	8.400	7083 62 2	
BEB/200	200	100	11.400	7083 62 6	
BEB/300	300	100	17.200	7083 63 0	
BEB/400	400	100	23.100	7083 63 4	
BEB/500	500	50	29.000	7083 63 8	
BEB/550	550	50	32.000	7083 64 0	
BEB/600	600	50	35.000	7083 64 2	



Bottom end plate for floor reinforcement at the ends of the cable tray and as cable protection.

For fastening, please order screws, type FRSB M6x12, separately.

Mounting plate

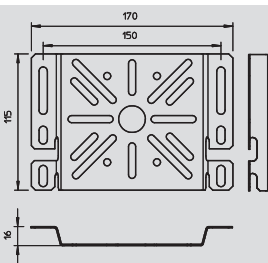

Type	Height mm	Width mm	Pack. pcs	Weight kg/% pc	Item No. ST / FS	Price €/pc
MP UNI	115	170	40	13.300	7084 77 3	
MP UNI	115	170	40	13.300	7085 11 4	



Mounting plate, for fastening on the side rail of cable support systems.

Fastening on the side rail of the mesh cable tray is carried out without screws by bending the lugs. Fastening on the side rail of cable trays or cable ladders is carried out with two truss-head screws. Type B9/T junction boxes can be mounted very easily by inserting the screw plug supplied into the centre hole on the mounting plate.

Please order the truss-head screw, type FRSB 6 x 12, separately.

System accessories:

FRSB 6x12 Truss-head bolt	See page	98
---------------------------	----------	----

Cable tray accessories 35, 60, 85, 110

Mounting plate



Type	Height mm	Width mm	Pack. pcs	Weight kg/% pc	Item No. ST / FS
<b>MP 225 UNI</b>	115	225	20	20.000	<b>7084 87 0</b>

Price  
€/pc

Mounting plate for universal use on side rails of cable trays and mesh cable trays.

Fastening on the side rail of the mesh cable tray is carried out without screws by bending the lugs. Fastening on the side rail of cable trays or cable ladders is carried out with two truss-head screws. Type B9/T junction boxes can be mounted very easily by inserting the screw plug supplied into the centre hole on the mounting plate.  
Please order the truss-head screw, type FR5B 6 x 12, separately.

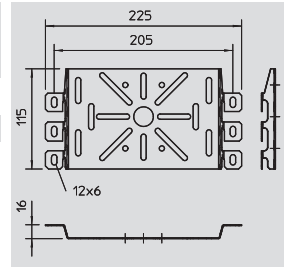

Type	Height mm	Width mm	Pack. pcs	Weight kg/% pc	Item No. ST / FS
<b>MP FL</b>	235	120	40	19.200	<b>7084 75 7</b>
<b>MP FL</b>	235	120	40	19.200	<b>7085 10 8</b>

Price  
€/pc

Flat mounting plate, for fixing on the side rail of the cable tray.

Type B9/T junction boxes can be mounted very easily by inserting the screw plug supplied into the centre hole on the mounting plate. Marked lugs provide rapid fastening.  
Please order the fastening screw, type FRS B6 x 12, separately.

**System accessories:**

FR5B 6x12 Truss-head bolt See page 98

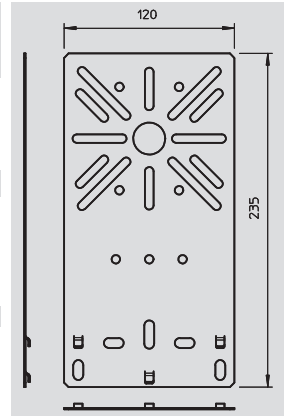

Type	Height mm	Width mm	Pack. pcs	Weight kg/% pc	Item No. ST / FS
<b>MP WI KL.</b>	210	120	20	20.200	<b>7084 76 5</b>
<b>MP WI KL.</b>	210	120	20	20.200	<b>7085 11 1</b>

Price  
€/pc

Curved mounting plate, for fastening on the side rail of the cable tray.

Type B9/T junction boxes can be mounted very easily by inserting the plug supplied into the centre hole on the mounting plate. Marked lugs provide rapid fastening.  
Please order the truss-head screw, type FRS B6 x 12, separately.

**System accessories:**

FR5B 6x12 Truss-head bolt See page 98

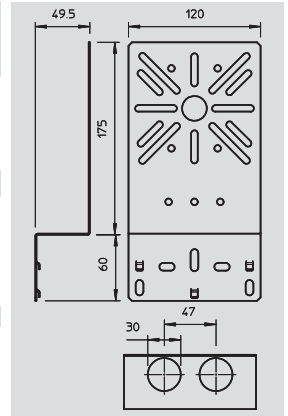

Type	Height mm	Width mm	Pack. pcs	Weight kg/% pc	Item No. ST / FS
<b>MP WI GR.</b>	240	200	25	40.000	<b>7084 78 1</b>
<b>MP WI GR.</b>	240	200	25	40.000	<b>7085 11 2</b>

Price  
€/pc

Curved mounting plate, for fixing on the side rail of the cable tray.

Type B9/T junction boxes can be mounted very easily by inserting the plug supplied into the centre hole on the mounting plate. Marked lugs provide rapid fastening.  
Please order the truss-head screw, type FRS B6 x 12, separately.

**System accessories:**

FR5B 6x12 Truss-head bolt See page 98

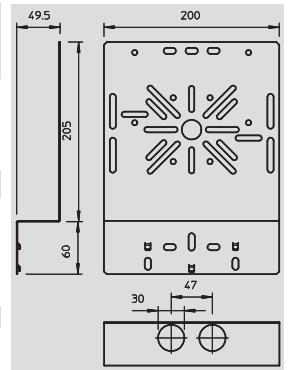

Cable tray accessories 35, 60, 85, 110



Edge protection strip



Type	for plate thickness mm	Dimension h mm	Colour	Length mm	Weight borders	Item No. PVC	Price €/m
KSB/2	1-2	10	black	10000	8.000	6072 90 9	
KSB/4	1-4	15	black	10000	14.000	6072 89 5	



Edge protection strip with steel inlay for covering the cut plate ends.

Cover

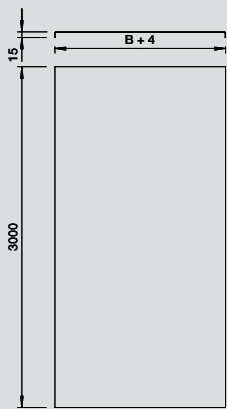

Type	Width mm	Plate thickness mm	Length mm	Weight borders	Item No. ST / FS	Price €/m
DRLU/050	50	0.75	3000	59.700	6052 05 6	
DRLU/100	100	0.75	3000	98.900	6052 10 3	
DRLU/150	150	0.75	3000	138.200	6052 15 3	
DRLU/200	200	1	3000	177.400	6052 21 0	
DRLU/300	300	1	3000	255.900	6052 30 7	
DRLU/400	400	1	3000	334.400	6052 40 5	
DRLU/500	500	1.25	3000	516.100	6052 51 2	
DRLU/550	550	1.25	3000	565.200	6052 57 1	
DRLU/600	600	1.25	3000	614.300	6052 60 9	
					ST / DD	
DRLU/050	50	0.75	3000	44.700	6052 64 0	
DRLU/100	100	0.75	3000	74.200	6052 64 3	
DRLU/150	150	0.75	3000	103.600	6052 64 7	
DRLU/200	200	1	3000	177.400	6052 65 0	
DRLU/300	300	1	3000	255.900	6052 65 6	
DRLU/400	400	1	3000	334.400	6052 66 2	
DRLU/500	500	1.25	3000	516.200	6052 66 8	
DRLU/550	550	1.25	3000	565.200	6052 67 1	
DRLU/600	600	1.25	3000	614.300	6052 67 4	



Cover for cable trays and mesh cable trays.

Transverse bead from 500 mm width.

System accessories:

DKU Cover clamp, universal See page 165

Cover clamp, universal

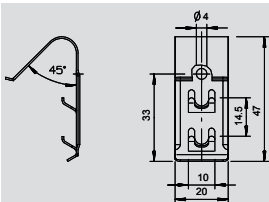

Type	Pack. pcs	Weight kg/% pc	Item No. V2A	Price €/pc
DKU	60	0.650	6065 60 0	
DKU	120	0.650	6065 61 0	



Cover clamp for universal fastening of covers on cable trays, mesh cable trays and AZ channels.

Depending on the tray width, 4 - 6 cover clamps are required for secure fastening of a 3 m cover.

System accessories:

DRLU Cover See page 165  
DRLU Cover See page 331

Cover clamp

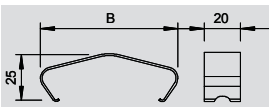

Type	Dimension B mm	Pack. pcs	Weight kg/% pc	Item No. V2A	Price €/pc
DKL 35	50.9	50	1.400	6065 50 3	
DKL 45	60.9	50	1.600	6065 51 1	
DKL 60	75.9	50	1.800	6065 53 8	
DKL 85	95.9	20	2.100	6065 54 6	
DKL 110	120.9	20	2.400	6065 55 4	



Cover clamp for secure fastening of covers on cable trays and cable ladders.

Cover clamp for additional fastening of the cover, e.g. in case of high wind load.

Cable tray accessories 35, 60, 85, 110

Cover with turn-buckle



Type	Width mm	Plate thickness mm	Length mm	Weight borders	Item No.
					ST / FS
DRL/050	50	0.75	3000	62.100	6052 05 3
DRL/075	75	0.75	3000	81.700	6052 02 9
DRL/100	100	0.75	3000	101.300	6052 09 6
DRL/150	150	1	3000	140.600	6052 15 0
DRL/200	200	1	3000	179.800	6052 20 7
DRL/300	300	1	3000	258.300	6052 30 4
DRL/400	400	1	3000	336.800	6052 40 1
DRL/500	500	1.25	3000	518.500	6052 50 9
DRL/550	550	1.25	3000	567.600	6052 56 8
DRL/600	600	1.25	3000	616.700	6052 60 6
ST / DD					
DRL/050	50	0.75	3000	45.900	6052 70 0
DRL/100	100	0.75	3000	76.600	6052 70 3
DRL/150	150	1	3000	106.000	6052 70 6
DRL/200	200	1	3000	179.800	6052 70 9
DRL/300	300	1	3000	258.300	6052 71 2
DRL/400	400	1	3000	336.800	6052 71 5
DRL/500	500	1.25	3000	518.400	6052 71 8
DRL/550	550	1.25	3000	567.600	6052 72 1
DRL/600	600	1.25	3000	616.700	6052 72 4

Price  
€/m

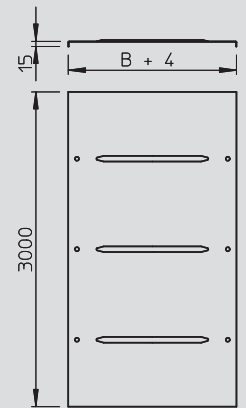

Cover for cable trays and cable ladders with three pairs of turn-buckles.

Transverse bead from 500 mm width.

Turn-buckle



Type	Pack. pcs	Weight kg/% pc	Item No.
			ST / FT
DRL 311	20	1.200	6065 00 7

Price  
€/pc

Turn-buckle for additional installation or installation at a later date.

Single-sided turn-buckle. Use for cover widths of 100 - 600 mm.

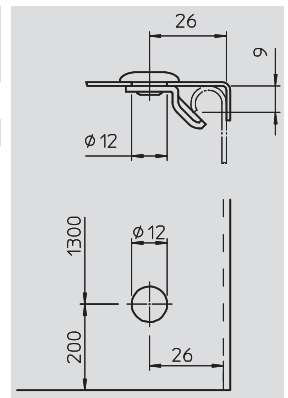

Type	Pack. pcs	Weight kg/% pc	Item No.
			ST / FT
DRL 311/2	20	1.700	6065 14 7

Price  
€/pc

Turn-buckle for additional installation or installation at a later date.

Turn-buckle on both sides. Use for cover width of 50 mm.

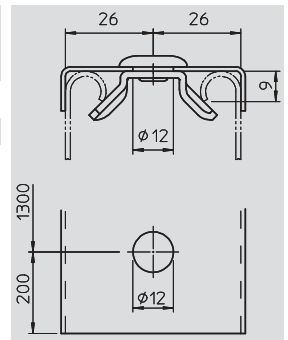

Type	Pack. pcs	Weight kg/% pc	Item No.
			ST / DD
DRLM 316	10	2.800	6222 36 6

Price  
€/pc

Turn-buckle for additional installation or installation at a later date.

Single-sided turn-buckle. Use for cover widths of 50 - 600 mm.

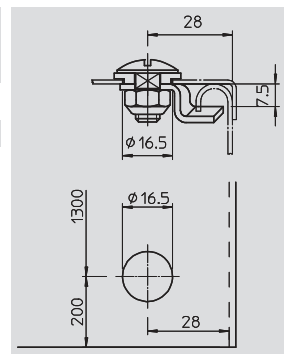

Cable tray accessories 35, 60, 85, 110

Cover for 45° bend

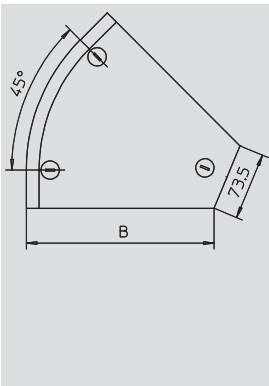

Type	Width mm	Plate thickness mm	Pack. pcs	Weight kg/% pc	Item No.		Price €/pc
					ST	FS	
DFB 45/100	100	1	1	16.600	7128 81 9		
DFB 45/150	150	1	1	24.600	7128 82 7		
DFB 45/200	200	1	1	34.600	7128 83 5		
DFB 45/300	300	1	1	57.600	7128 85 1		
						ST / DD	
DFB 45/050	50	1	1	23.000	7131 80 1		
DFB 45/100	100	1	1	16.600	7131 82 8		
DFB 45/150	150	1	1	24.600	7131 83 6		
DFB 45/200	200	1	1	34.600	7131 84 4		
DFB 45/300	300	1	1	57.600	7131 86 0		



Cover for 45° bend with pre-mounted turn-buckle.

The cover can be used with fittings of all side heights.

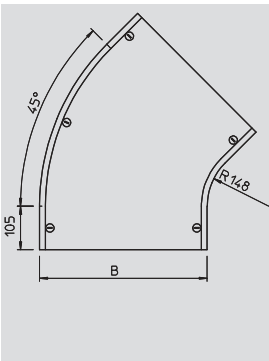

Type	Width mm	Plate thickness mm	Pack. pcs	Weight kg/% pc	Item No.		Price €/pc
					ST	FS	
DFB 45/400	400	1.25	1	216.000	7128 88 6		
DFB 45/500	500	1.25	1	284.000	7128 90 8		
DFB 45/550	550	1.25	1	321.000	7128 91 6		
DFB 45/600	600	1.25	1	360.000	7128 92 4		
						ST / DD	
DFB 45/400	400	1.25	1	216.000	7131 87 9		
DFB 45/500	500	1.25	1	284.000	7131 88 7		
DFB 45/550	550	1.25	1	321.000	7131 89 5		
DFB 45/600	600	1.25	1	426.000	7131 90 9		



Cover for 45° bend with pre-mounted turn-buckle.

The cover can be used with fittings of all side heights.

Cover for 90° bend

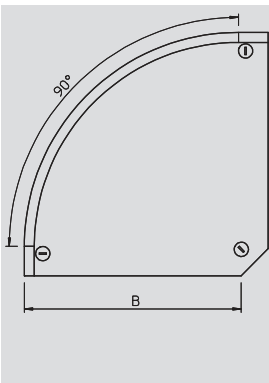

Type	Width mm	Plate thickness mm	Pack. pcs	Weight kg/% pc	Item No.		Price €/pc
					ST	FS	
DFB 90/100	100	1	1	21.400	7129 61 0		
DFB 90/150	150	1	1	37.600	7129 62 9		
DFB 90/200	200	1	1	54.200	7129 63 7		
DFB 90/300	300	1	1	96.400	7129 65 3		
						ST / DD	
DFB 90/050	50	1	1	52.000	7130 50 3		
DFB 90/100	100	1	1	21.400	7130 51 1		
DFB 90/150	150	1	1	37.600	7130 53 8		
DFB 90/200	200	1	1	54.200	7130 54 6		
DFB 90/300	300	1	1	96.400	7130 56 2		



Cover for 90° bend with pre-mounted turn-buckles.

The cover can be used with fittings of all side heights.

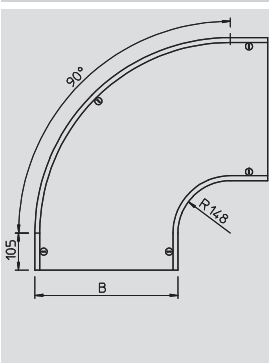

Type	Width mm	Plate thickness mm	Pack. pcs	Weight kg/% pc	Item No.		Price €/pc
					ST	FS	
DFB 90/400	400	1.25	1	336.000	7129 68 8		
DFB 90/500	500	1.25	1	451.000	7129 71 8		
DFB 90/550	550	1.25	1	518.000	7129 72 6		
DFB 90/600	600	1.25	1	585.000	7129 73 4		
						ST / DD	
DFB 90/400	400	1.25	1	336.000	7130 58 9		
DFB 90/500	500	1.25	1	451.000	7130 60 0		
DFB 90/550	550	1.25	1	613.000	7130 61 9		
DFB 90/600	600	1.25	1	695.000	7130 62 7		



Cover for 90° bend with pre-mounted turn-buckles.

The cover can be used with fittings of all side heights.

Cable tray accessories 35, 60, 85, 110

Cover for add-on tee



Type	Width mm	Plate thickness mm	Pack. pcs	Weight kg/% pc	Item No.	
					ST	FS
DFAA/100	100	1	1	18.000	7128	42 8
DFAA/150	150	1	1	23.000	7128	43 6
DFAA/200	200	1	1	28.000	7128	44 4
DFAA/300	300	1	1	38.000	7128	46 0
					ST	DD
DFAA/050	50	1	1	15.000	7131	29 1
DFAA/100	100	1	1	20.000	7131	30 5
DFAA/150	150	1	1	25.000	7131	31 0
DFAA/200	200	1	1	30.000	7131	32 1
DFAA/300	300	1	1	40.000	7131	34 8

Price  
€/pc

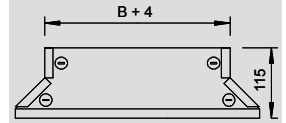

Cover for add-on tee with pre-mounted turn-buckles.

The cover can be used with fittings of all side heights.



Type	Width mm	Plate thickness mm	Pack. pcs	Weight kg/% pc	Item No.	
					ST	FS
DFAA/400	400	1.25	1	150.000	7128	48 7
DFAA/500	500	1.25	1	170.000	7128	50 9
DFAA/550	550	1.25	1	185.000	7128	51 7
DFAA/600	600	1.25	1	200.000	7128	52 5
					ST	DD
DFAA/400	400	1.25	1	152.000	7131	35 6
DFAA/500	500	1.25	1	172.000	7131	36 4
DFAA/550	550	1.25	1	187.000	7131	37 2
DFAA/600	600	1.25	1	202.000	7131	38 0

Price  
€/pc

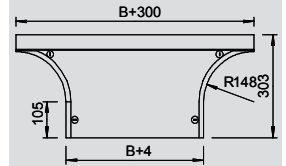

Cover for add-on tee with pre-mounted turn-buckles.

The cover can be used with fittings of all side heights.

Cover for tee



Type	Width mm	Plate thickness mm	Pack. pcs	Weight kg/% pc	Item No.	
					ST	FS
DFT/100	100	1	1	25.000	7128	21 5
DFT/150	150	1	1	40.000	7128	22 3
DFT/200	200	1	1	60.000	7128	23 1
DFT/300	300	1	1	115.000	7128	26 6
					ST	DD
DFT/050	50	1	1	15.000	7129	30 0
DFT/100	100	1	1	27.000	7129	31 9
DFT/150	150	1	1	45.000	7129	32 7
DFT/200	200	1	1	65.000	7129	33 5
DFT/300	300	1	1	125.000	7129	35 1

Price  
€/pc

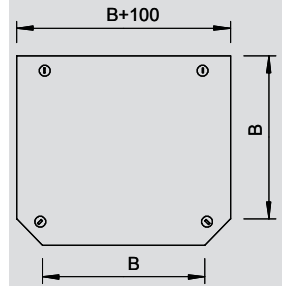

Cover for tee with pre-mounted turn-buckle.

The cover can be used with fittings of all side heights.



Type	Width mm	Plate thickness mm	Pack. pcs	Weight kg/% pc	Item No.	
					ST	FS
DFT/400	400	1.25	1	500.000	7128	28 2
DFT/500	500	1.25	1	670.000	7128	30 4
DFT/550	550	1.25	1	750.000	7128	31 2
DFT/600	600	1.25	1	850.000	7128	32 0
					ST	DD
DFT/400	400	1.25	1	620.000	7129	38 6
DFT/500	500	1.25	1	820.000	7129	40 8
DFT/550	550	1.25	1	930.000	7129	41 6
DFT/600	600	1.25	1	1050.000	7129	42 4

Price  
€/pc

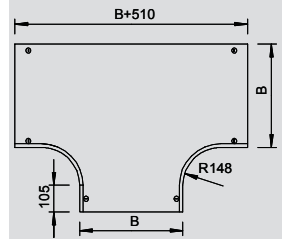

Cover for tee with pre-mounted turn-buckle.

The cover can be used with fittings of all side heights.

Cable tray accessories 35, 60, 85, 110

Cover for cross-over

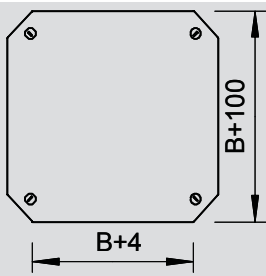

Type	Width mm	Plate thickness mm	Pack. pcs	Weight kg/% pc	Item No. ST / FS	Price €/pc
DFK/100	100	1	1	30.000	7128 61 4	
DFK/150	150	1	1	45.000	7128 62 2	
DFK/200	200	1	1	70.000	7128 63 0	
DFK/300	300	1	1	125.000	7128 65 7	
					ST / DD	
DFK/100	100	1	1	33.000	7131 08 9	
DFK/150	150	1	1	49.000	7131 09 7	
DFK/200	200	1	1	77.000	7131 10 0	
DFK/300	300	1	1	137.000	7131 12 7	



Cover for cross-over with pre-mounted turn-buckles.

The cover can be used with fittings of all side heights.

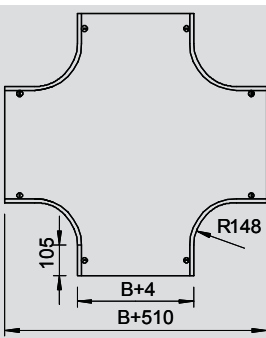

Type	Width mm	Plate thickness mm	Pack. pcs	Weight kg/% pc	Item No. ST / FS	Price €/pc
DFK/400	400	1.25	1	620.000	7128 67 3	
DFK/500	500	1.25	1	810.000	7128 70 3	
DFK/550	550	1.25	1	910.000	7128 71 1	
DFK/600	600	1.25	1	1020.000	7128 73 8	
					ST / DD	
DFK/400	400	1.25	1	760.000	7131 14 3	
DFK/500	500	1.25	1	1010.000	7131 17 8	
DFK/550	550	1.25	1	1120.000	7131 18 6	
DFK/600	600	1.25	1	1260.000	7131 19 4	



Cover for cross-over with pre-mounted turn-buckles.

The cover can be used with fittings of all side heights.

Cover for 90° vertical bend

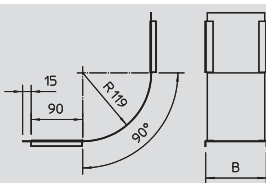

Type	Width mm	Plate thickness mm	Pack. pcs	Weight kg/% pc	Item No. ST / FS	Price €/pc
DBV 050 S	50	0.75	1	18.000	7130 80 1	
DBV 100 S	100	0.75	1	29.000	7130 80 5	
DBV 150 S	150	0.75	1	39.000	7130 80 9	
DBV 200 S	200	0.75	1	50.000	7130 81 3	
DBV 300 S	300	0.75	1	72.000	7130 81 7	
DBV 400 S	400	0.75	1	94.000	7130 82 1	
DBV 500 S	500	0.75	1	115.000	7130 82 5	
DBV 600 S	600	0.75	1	137.000	7130 82 9	



Cover for rising vertical bend.

The fastening is guaranteed by the overlap of the cable tray lids. The cover can also be fastened using cover clamps.

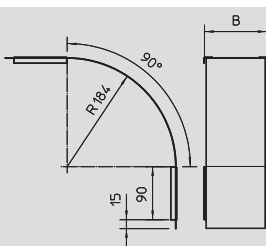

Type	Width mm	Plate thickness mm	Pack. pcs	Weight kg/% pc	Item No. ST / FS	Price €/pc
DBV 050 F	50	0.75	1	21.000	7130 84 7	
DBV 100 F	100	0.75	1	35.000	7130 85 2	
DBV 150 F	150	0.75	1	48.000	7130 85 6	
DBV 200 F	200	0.75	1	62.000	7130 86 0	
DBV 300 F	300	0.75	1	89.000	7130 86 4	
DBV 400 F	400	0.75	1	117.000	7130 86 8	
DBV 500 F	500	0.75	1	145.000	7130 87 2	
DBV 600 F	600	0.75	1	173.000	7130 87 6	



Cover for falling vertical bend.

The fastening is guaranteed by the overlap of the cable tray lids. The cover can also be fastened using cover clamps.