

Glands - brass - EEx e, EEx d, IP 66 / IP 68, for non-armoured cable

Cable entries

B



EEx e and EEx d brass cable gland for non-armoured cable

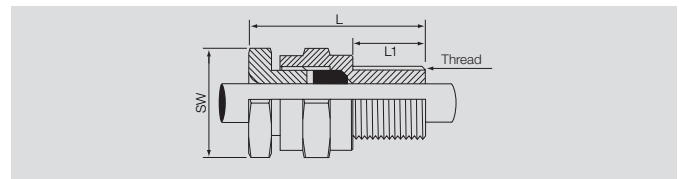

Technical data

Material	brass, nickel-plated brass
Sealing ring / Sealing insert	/ NBR
Temperature range	-20 °C ... 85 °C
Class of protection / with GWDR	- / IP 66, IP 68 - 2.5 bar
Approval	Ⓜ II 2 GD EEx e II; EEx d IIC / Ⓜ II 2 GD Ex e II; Ex d IIC
Test certificate	SIRA 01ATEX1272X / IECEX SIR 05.0020X
Note	Length L varies according to cable diameter used.

Ordering data

Type	Thread-size	KB	L/L1	SW	Qty.	Order No.
metric, brass						
VG M16-1/Exe/d MSN	M 16 x 1.5	4 - 8.4	49 / 16	25	1	1909380000
VG M20-1/Exe/d MSN	M 20 x 1.5	4 - 8.4	49 / 16	25	1	1909390000
VG M20-1/Exe/d MSN	M 20 x 1.5	7.2 - 11.7	49 / 16	25	1	1909400000
VG M20-1/Exe/d MSN	M 20 x 1.5	9.6 - 14	49 / 16	30	1	1909410000
VG M25-1/Exe/d MSN	M 25 x 1.5	13.5 - 20	49 / 16	38	1	1909420000
VG M32-1/Exe/d MSN	M 32 x 1.5	19.5 - 26.3	49 / 16	46	1	1909430000
VG M40-1/Exe/d MSN	M 40 x 1.5	23 - 32.2	53 / 16	55	1	1909440000
VG M50-1/Exe/d MSN	M 50 x 1.5	28.2 - 38.2	53 / 16	65	1	1909450000
VG M50-1/Exe/d MSN	M 50 x 1.5	33.2 - 44.1	53 / 16	65	1	1909460000
VG M63-1/Exe/d MSN	M 63 x 1.5	39.3 - 50.1	56 / 19	80	1	1909470000
VG M63-1/Exe/d MSN	M 63 x 1.5	46.7 - 56	56 / 19	80	1	1909480000
metric, nickel-plated brass						
VG M16-1/Exe/d MS	M 16 x 1.5	4 - 8.4	49 / 16	25	1	1911510000
VG M20-1/Exe/d MS	M 20 x 1.5	4 - 8.4	49 / 16	25	1	1911530000
VG M20-1/Exe/d MS	M 20 x 1.5	7.2 - 11.7	49 / 16	25	1	1911540000
VG M20-1/Exe/d MS	M 20 x 1.5	9.6 - 14	49 / 16	30	1	1911560000
VG M25-1/Exe/d MS	M 25 x 1.5	13.5 - 20	49 / 16	38	1	1911570000
VG M32-1/Exe/d MS	M 32 x 1.5	19.5 - 26.3	49 / 16	46	1	1911580000
VG M40-1/Exe/d MS	M 40 x 1.5	23 - 32.2	53 / 16	55	1	1911590000
VG M50-1/Exe/d MS	M 50 x 1.5	28.2 - 38.2	53 / 16	65	1	1911600000
VG M50-1/Exe/d MS	M 50 x 1.5	33.2 - 44.1	53 / 16	65	1	1911610000
VG M63-1/Exe/d MS	M 63 x 1.5	39.3 - 50.1	56 / 19	80	1	1911620000
VG M63-1/Exe/d MS	M 63 x 1.5	46.7 - 56	56 / 19	80	1	1911630000

Further versions - also in stainless steel - available on request

Glands - brass - EEx e, EEx d, IP 66 / IP 68, for armoured cable



EEx e and EEx d brass cable gland for armoured cable

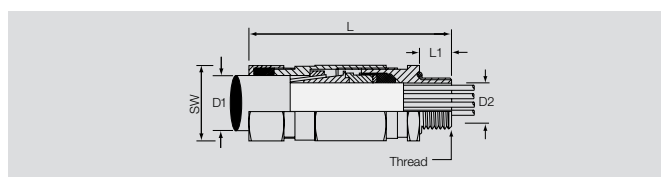

Technical data

Material	brass, nickel-plated brass
Sealing ring / Sealing insert	/ NBR
Temperature range	-20 °C ... 85 °C
Class of protection / with GWDR	- / IP 66, IP 68 - 2.5 bar
Approval	Ⓜ II 2 GD EEx e II; EEx d IIC / Ⓜ II 2 GD Ex e II; Ex d IIC
Test certificate	BAS01ATEX2271X / IECEx SIR 05.0020X

Note Length L varies according to cable diameter used.

Ordering data

Type	Thread-size	D1 cable O.D.	Armour	D2 cable I.D.	L/L1	SW	Qty.	Order No.
metric, brass								
VG M20-1/Exe/d A MSN	M 20 x 1.5	9 - 13.5	0.15 - 1.25	3.4 - 8.4	94 / 16	25	1	1909260000
VG M20-1/Exe/d A MSN	M 20 x 1.5	11.5 - 16	0.15 - 1.25	7.2 - 11.7	94 / 16	25	1	1909290000
VG M20-1/Exe/d A MSN	M 20 x 1.5	15.5 - 21.1	0.15 - 1.25	9.4 - 14	94 / 16	30	1	1909300000
VG M25-1/Exe/d A MSN	M 25 x 1.5	20.3 - 27.4	0.15 - 1.6	13.5 - 20	106 / 16	38	1	1909310000
VG M32-1/Exe/d A MSN	M 32 x 1.5	26.7 - 34	0.15 - 2	19.5 - 26.3	121 / 16	46	1	1909320000
VG M40-1/Exe/d A MSN	M 40 x 1.5	33 - 40.6	0.2 - 2	23 - 32.2	129 / 16	55	1	1909330000
VG M50-1/Exe/d A MSN	M 50 x 1.5	39.4 - 46.7	0.3 - 2.5	28.1 - 38.2	141 / 16	65	1	1909340000
VG M50-1/Exe/d A MSN	M 50 x 1.5	45.7 - 53.2	0.3 - 2.5	33.1 - 44.1	141 / 16	65	1	1909350000
VG M63-1/Exe/d A MSN	M 63 x 1.5	52.1 - 59.5	0.3 - 2.5	39.2 - 50.1	144 / 19	80	1	1909360000
VG M63-1/Exe/d A MSN	M 63 x 1.5	58.4 - 65.8	0.3 - 2.5	46.7 - 56	144 / 19	80	1	1909370000
metric, nickel-plated brass								
VG M20-1/Exe/d A MS	M 20 x 1.5	9 - 13.5	0.15 - 1.25	3.4 - 8.4	94 / 16	25	1	1911380000
VG M20-1/Exe/d A MS	M 20 x 1.5	11.5 - 16	0.15 - 1.25	7.2 - 11.7	94 / 16	25	1	1911390000
VG M20-1/Exe/d A MS	M 20 x 1.5	15.5 - 21.1	0.15 - 1.25	9.4 - 14	94 / 16	30	1	1911400000
VG M25-1/Exe/d A MS	M 25 x 1.5	20.3 - 27.4	0.15 - 1.6	13.5 - 20	106 / 16	38	1	1911420000
VG M32-1/Exe/d A MS	M 32 x 1.5	26.7 - 34	0.15 - 2	19.5 - 26.3	121 / 16	46	1	1911430000
VG M40-1/Exe/d A MS	M 40 x 1.5	33 - 40.6	0.2 - 2	23 - 32.2	129 / 16	55	1	1911440000
VG M50-1/Exe/d A MS	M 50 x 1.5	39.4 - 46.7	0.3 - 2.5	28.1 - 38.2	141 / 16	65	1	1911450000
VG M50-1/Exe/d A MS	M 50 x 1.5	45.7 - 53.2	0.3 - 2.5	33.1 - 44.1	141 / 16	65	1	1911460000
VG M63-1/Exe/d A MS	M 63 x 1.5	52.1 - 59.5	0.3 - 2.5	39.2 - 50.1	144 / 19	80	1	1911480000
VG M63-1/Exe/d A MS	M 63 x 1.5	58.4 - 65.8	0.3 - 2.5	46.7 - 56	144 / 19	80	1	1911490000

Further versions - also in stainless steel - available on request

Cable glands for Ex applications - brass

Glands - brass - EEx e, EEx d, IP 66 / IP 68, for non-armoured cable



EEx e and EEx d brass cable gland for non-armoured cable

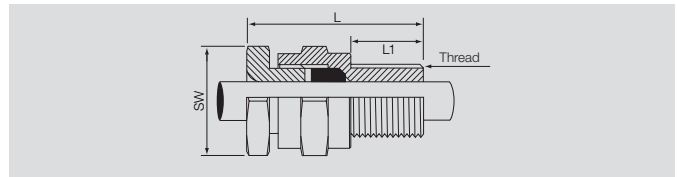

Technical data

Material	brass, nickel-plated brass
Sealing ring / Sealing insert	Silicone / NBR
Temperature range	-60 °C ... +180 °C
Class of protection / with GWDR	- / IP 66, IP 68 - 2.5 bar
Approval	Ⓜ II 2 GD EEx e II; EEx d IIC / Ⓜ II 2 GD Ex e II; Ex d IIC
Test certificate	SIRA 01ATEX1272X / IECEx SIR 05.0020X

Note Length L varies according to cable diameter used.

Ordering data

Type	Thread-size	KB	L/L1	SW	Qty.	Order No.
metric, brass						
VG M16-1/Exe/d HT MSN	M 16 x 1.5	4 - 8.4	49 / 16	25	1	1926030000
VG M20-1/Exe/d HT MSN	M 20 x 1.5	4 - 8.4	49 / 16	25	1	1926040000
VG M20-1/Exe/d HT MSN	M 20 x 1.5	7.2 - 11.7	49 / 16	25	1	1926050000
VG M20-1/Exe/d HT MSN	M 20 x 1.5	9.6 - 14	49 / 16	30	1	1926060000
VG M25-1/Exe/d HT MSN	M 25 x 1.5	13.5 - 20	49 / 16	38	1	1926070000
VG M32-1/Exe/d HT MSN	M 32 x 1.5	19.5 - 26.3	49 / 16	46	1	1926080000
VG M40-1/Exe/d HT MSN	M 40 x 1.5	23 - 32.2	53 / 16	55	1	1926090000
VG M50-1/Exe/d HT MSN	M 50 x 1.5	28.2 - 38.2	53 / 16	65	1	1926100000
VG M50-1/Exe/d HT MSN	M 50 x 1.5	33.2 - 44.1	53 / 16	65	1	1926110000
VG M63-1/Exe/d HT MSN	M 63 x 1.5	39.3 - 50.1	56 / 19	80	1	1926120000
VG M63-1/Exe/d HT MSN	M 63 x 1.5	46.7 - 56	56 / 19	80	1	1926130000
metric, nickel-plated brass						
VG M16-1/Exe/d HT MS	M 16 x 1.5	4 - 8.4	49 / 16	25	1	1932910000
VG M20-1/Exe/d HT MS	M 20 x 1.5	4 - 8.4	49 / 16	25	1	1932940000
VG M20-1/Exe/d HT MS	M 20 x 1.5	7.2 - 11.7	49 / 16	25	1	1932960000
VG M20-1/Exe/d HT MS	M 20 x 1.5	9.6 - 14	49 / 16	30	1	1932970000
VG M25-1/Exe/d HT MS	M 25 x 1.5	13.5 - 20	49 / 16	38	1	1932980000
VG M32-1/Exe/d HT MS	M 32 x 1.5	19.5 - 26.3	49 / 16	46	1	1932990000
VG M40-1/Exe/d HT MS	M 40 x 1.5	23 - 32.2	53 / 16	55	1	1933000000
VG M50-1/Exe/d HT MS	M 50 x 1.5	28.2 - 38.2	53 / 16	65	1	1933010000
VG M50-1/Exe/d HT MS	M 50 x 1.5	33.2 - 44.1	53 / 16	65	1	1933020000
VG M63-1/Exe/d HT MS	M 63 x 1.5	39.3 - 50.1	56 / 19	80	1	1933030000
VG M63-1/Exe/d HT MS	M 63 x 1.5	46.7 - 56	56 / 19	80	1	1933040000

Further versions - also in stainless steel - available on request

Glands - brass - EEx e, EEx d, IP 66 / IP 68, for armoured cable



EEx e and EEx d brass cable gland for armoured cable

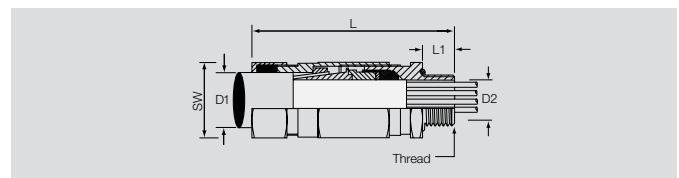

Technical data

Material	brass, nickel-plated brass
Sealing ring / Sealing insert	Silicone / NBR
Temperature range	-60 °C ... +180 °C
Class of protection / with GWDR	- / IP 66, IP 68 - 2.5 bar
Approval	Ⓜ II 2 GD EEx e II; EEx d IIC / Ⓜ II 2 GD Ex e II; Ex d IIC
Test certificate	BAS01ATEX2271X / IECEx SIR 05.0020X

Note Length L varies according to cable diameter used.

Ordering data

Type	Thread-size	D1 cable O.D.	Armour	D2 cable I.D.	L/L1	SW	Qty.	Order No.
metric, brass								
VG M20-1/Exe/d A HT MSN	M 20 x 1.5	9 - 13.5	0.15 - 1.25	3.4 - 8.4	94 / 16	25	1	1925920000
VG M20-1/Exe/d A HT MSN	M 20 x 1.5	11.5 - 16	0.15 - 1.25	7.2 - 11.7	94 / 16	25	1	1925930000
VG M20-1/Exe/d A HT MSN	M 20 x 1.5	15.5 - 21.1	0.15 - 1.25	9.4 - 14	94 / 16	30	1	1925940000
VG M25-1/Exe/d A HT MSN	M 25 x 1.5	20.3 - 27.4	0.15 - 1.6	13.5 - 20	106 / 16	38	1	1925950000
VG M32-1/Exe/d A HT MSN	M 32 x 1.5	26.7 - 34	0.15 - 2	19.5 - 26.3	121 / 16	46	1	1925960000
VG M40-1/Exe/d A HT MSN	M 40 x 1.5	33 - 40.6	0.2 - 2	23 - 32.2	129 / 16	55	1	1925970000
VG M50-1/Exe/d A HT MSN	M 50 x 1.5	39.4 - 46.7	0.3 - 2.5	28.1 - 38.2	141 / 16	65	1	1925980000
VG M50-1/Exe/d A HT MSN	M 50 x 1.5	45.7 - 53.2	0.3 - 2.5	33.1 - 44.1	141 / 16	65	1	1925990000
VG M63-1/Exe/d A HT MSN	M 63 x 1.5	52.1 - 59.5	0.3 - 2.5	39.2 - 50.1	144 / 19	80	1	1926000000
VG M63-1/Exe/d A HT MSN	M 63 x 1.5	58.4 - 65.8	0.3 - 2.5	46.7 - 56	144 / 19	80	1	1926010000
metric, nickel-plated brass								
VG M20-1/Exe/d A HT MS	M 20 x 1.5	9 - 13.5	0.15 - 1.25	3.4 - 8.4	94 / 16	25	1	1933050000
VG M20-1/Exe/d A HT MS	M 20 x 1.5	11.5 - 16	0.15 - 1.25	7.2 - 11.7	94 / 16	25	1	1933060000
VG M20-1/Exe/d A HT MS	M 20 x 1.5	15.5 - 21.1	0.15 - 1.25	9.4 - 14	94 / 16	30	1	1933070000
VG M25-1/Exe/d A HT MS	M 25 x 1.5	20.3 - 27.4	0.15 - 1.6	13.5 - 20	106 / 16	38	1	1933080000
VG M32-1/Exe/d A HT MS	M 32 x 1.5	26.7 - 34	0.15 - 2	19.5 - 26.3	121 / 16	46	1	1933090000
VG M40-1/Exe/d A HT MS	M 40 x 1.5	33 - 40.6	0.2 - 2	23 - 32.2	129 / 16	55	1	1933100000
VG M50-1/Exe/d A HT MS	M 50 x 1.5	39.4 - 46.7	0.3 - 2.5	28.1 - 38.2	141 / 16	65	1	1933110000
VG M50-1/Exe/d A HT MS	M 50 x 1.5	45.7 - 53.2	0.3 - 2.5	33.1 - 44.1	141 / 16	65	1	1933120000
VG M63-1/Exe/d A HT MS	M 63 x 1.5	52.1 - 59.5	0.3 - 2.5	39.2 - 50.1	144 / 19	80	1	1933130000
VG M63-1/Exe/d A HT MS	M 63 x 1.5	58.4 - 65.8	0.3 - 2.5	46.7 - 56	144 / 19	80	1	1933140000

Further versions - also in stainless steel - available on request